

TP

LASCON

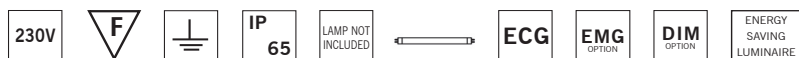

An enclosed, high protection luminaire offering features such as moisture and dust proof. A locally designed luminaire developed for maximum security applications and offers an ideal lighting solution for the prison environment. Approved by the department of correctional services

- Vandal-resistant, making accessibility virtually impossible and thereby ensuring complete safety for both prison inmates and staff
- Tamper proof screws hold the diffuser into place and are removable with a special tool
- The body has been designed with vertical sides that when attached tightly against the mounting surface, not only eliminates possible hiding places for contraband items, but also makes any form of hand leverage or grip on the luminaire impossible
- Available with a 1 x 9W compact fluorescent night light



TP-236-ELB

BODY – Cold rolled mild steel with white epoxy powder coated finish

LAMP HOLDERS – Bi-pin, rota-lock lamp holders designed for use with T8 26mm diameter fluorescent lamps

DIFFUSER – One-piece injection moulded self extinguishing UV stabilised polycarbonate. Linear light control prisms are moulded on the inside leaving the outside perfectly smooth

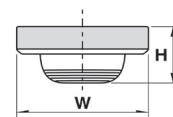
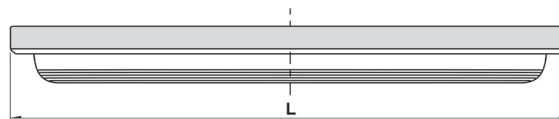

PRODUCT CODE	Watts	L	W	H	Kg
TP-136-ELB	1 x 36W	1290mm	210mm	120mm	7,0
TP-236-ELB	2 x 36W	1290mm	210mm	120mm	8,0
TP-158-ELB	1 x 58W	1590mm	210mm	120mm	8,8
TP-258-ELB	2 x 58W	1590mm	210mm	120mm	9,8

Options: add suffix to product code

- .../GAL Electro galvanised mild steel body prior to painting
- .../NL Night Light
- .../DIM Dimmable Ballast
- .../EMG Emergency Mode

TP

LASCON

PHOTOMETRIC DATA



TP-258-ELB

Zone	0-60	60-90	Down	Up	Total
% of lamp	36.0	15.1	51.1	6.3	57.4

Reflection Factors			Coefficients of utilization for a ratio of S/Hm -1.50									
Floor	Ceiling	Walls	0.60	0.80	1.00	1.25	1.50	2.00	2.50	3.00	4.00	5.00
0.1	0.7	0.5		0.31	0.36	0.39	0.42	0.46	0.48	0.50	0.53	0.54
		0.3	0.27	0.31	0.35	0.38	0.42	0.45	0.48	0.50	0.52	
	0.1	0.24	0.28	0.31	0.35	0.39	0.42	0.45	0.48	0.50		
	0.5	0.5	0.30	0.34	0.37	0.40	0.43	0.46	0.48	0.50	0.52	
		0.3	0.26	0.30	0.34	0.36	0.40	0.43	0.45	0.48	0.50	
	0.1	0.23	0.27	0.31	0.33	0.37	0.41	0.43	0.46	0.48		
0.3	0.5	0.29	0.32	0.36	0.37	0.41	0.43	0.46	0.47	0.49		
	0.3	0.25	0.29	0.32	0.35	0.39	0.41	0.43	0.46	0.48		
0.1	0.22	0.26	0.29	0.32	0.36	0.39	0.41	0.44	0.46			
BZ Classification			6	6	6	6	6	6	6	6	6	6

